



RBDMS EVENTS

Energy & Water Software | Data Solutions

A Product of the Ground Water Protection Council & the U.S. Department of Energy



Annual Training

April 2 – 6, 2017 | Sarasota, Florida

Lido Beach Resort

700 Ben Franklin Drive

(See Last Page for Hotel Map)

Agenda

Sunday April 2

1:00 – 5:00 RBDMS Committee Meetings: *Sunset Terrace, 8th Floor*

User Interface Recommendations:

- Summary of UI focus group recommendations
- Evaluation of the Utah and Michigan new data miner sites
- Recommendations for next steps

UIC Committee:

- Provide overview of previous work
- Questionnaire results
- Review primary additions to system
- Additional data elements to be collected
- Possible GIS / Well bore ties
 - a. User Interface / MVC
 - b. Mapping directional/horizontal well paths (Jim Milne 45 minutes)
 - c. RBDMS standard for directional/horizontal
 - d. AOR

WellFinder Committee:

- Updates on new features

- Feedback from beta testing
 - a. Download the wellfinder beta:
 - i. Android: [Click here to download](#)
 - ii. iOS: Email tjgroves@gwpc.org for an invite

GIS Committee:

- Introductions and discussion of committee functions
- Status of ongoing RBDMS GIS projects
- GIS survey results
- Draft GIS comprehensive plan
- Group discussion
- Use of power BI

6:00 – 8:00 Evening Networking: *South Tower Room 1213*

Monday April 3

8:00 Breakfast: *Reception Area, 8th Floor*

9:00 – 12:00 Morning Session: *Sunset Terrace, 8th Floor*

Introductions: Paul Jehn

State Roundtable:

California: Thom Kerr	Ohio: Joe Lee	Utah: Dan Jarvis/Dave Lowther
Wyoming: Tom Kropatsch/Dave Lowther	Michigan : Adam Wygant/Don Drazan	West Virginia: April Sun/Don Drazan
Arkansas: Dan Pearson/Dave Lowther	Oklahoma: Dave Lowther	North Dakota: Mark Bohrer
Colorado: Ken Robertson	Other States: Submit Talking Points	

RBDMS National View: Paul Jehn

RBDMS/WellSTAR Architecture Update

- Architecture overview
- Deep dive into rules, workflow, and online forms
- Overview of designing forms
- Method for bulk transfer of forms
- Schedule of forms in release 1 and 2
- Review detailed design document
- Review rule engine developer documentation – *this will show what will be available in the future on the RBDMS Developer Wiki*

1:30 – 5:00

Afternoon Session: *Sunset Terrace, 8th Floor*

RBDMS/WellSTAR Reference Application Demo

- Using WellSTAR Online Forms reference application to submit designate agent form
- WellSTAR reports
- Adhoc & SSRS – demo

Hands on with Power BI: (*Chris Eisinger COGCC 60 minutes*)

- Overview of Power BI and business analytics services (interactive dashboards)
- Colorado data
- COGCC implementation of Power BI
- Limitations & pitfalls
- Guided hands-on exercise
- Setup Power BI Desktop – [Download Power BI desktop here](#)
- Prep and access data
- Create sample reports & dashboards
- Customize

GIS: Hands On

- The future of RBDMS GIS Offerings – A proposed GIS Comprehensive Plan (*Jim Milne – 45 minutes*)
- Creating and using spatial queries to conduct intersect analyses (*Ken Robertson – 45 minutes*)

6:00 – 8:00

Evening Networking – *South Tower Room 1213*

Tuesday April 4

8:00

Breakfast: *Reception Area, 8th Floor*

9:00 – 12:00

Morning Session: *Sunset Terrace, 8th Floor*

RBDMS National Configuration Management Update: (Paul Jehn/TJ Groves)

- RBDMS governance
- Overview configuration management approach
- Review updated GitHub configuration and defect management process
- RBDMS developer Wiki overview
- Intent and structure of the wiki
- RBDMSonline.org

RBDMS 3.0

- RBDMS 3.0 upgrade analysis
 - a. New initiative to start gathering information on each project to further refine upgrade paths and options
 - b. Steps to initiate a RBDMS 3.0 upgrade
- RBDMS 3.0 software as a service
 - a. Architecture and deployment model

- b. Separation of data
- c. Configurable aspects of RBDMS 3.0

Wellfinder – status and next steps (TJ Groves)

- Download the wellfinder beta:
 - a. Android: [Click here to download](#)
 - b. iOS: Email tjgroves@gwpc.org for an invite

Possible Data Elements for Recording Spill and Cleanup Activities: (Kate Konschnik)

1:30 – 5:00

Afternoon Session: *Sunset Terrace, 8th Floor*

Field Inspection: *Hands on (Thom Kerr) (2 hours)*

- Summary of project status
- Demo walk through of application
- User testing and commenting (pilot results)
- Discussion and feedback on COA/BMP
- Discussion and feedback on inspection prioritization
- Discussion and feedback on needed features

FormBuilder (Anthony DeBonis) (Hands On)

- About Form Builder
 - a. History and What is FormBuilder
 - b. NY Forms Status
 - c. New and Exciting Features
- Using FormBuilder - Hands On Session
 - a. Creating your 1st form
 - b. Creating Sections and Form Fields
 - c. Making reusable sections
 - d. Setting Form/Sections Active
 - e. Submitting a form as - as an Operator
 - f. Approving a submitted form - as a Reviewer/Approver
- What's Next
 - a. Integrate with WellStar? RBDMS 3.0
- Requested Features / Feedback

6:00 – 8:00

Evening Networking: *South Tower Room 1213*

Wednesday, April 5

8:00

Breakfast: *Reception Area, 8th Floor*

9:00 – 12:00

Morning Session: *Sunset Terrace, 8th Floor*

Wellbore Diagram Installation: *Hands On* - How to install wellbore in your state.

- About Wellbore
 - a. 5 min history and what Wellbore does
 - b. New and Exciting Features
 - c. Demonstrate Wellbore basic features

- Using Wellbore - Hands on Session
 - a. Loading the Wellbore - URL/ Address
 - b. Choosing a Well from drop down
 - c. Base API is read from application 10 or 14 (14 by default)
 - d. Note Dropdown is grouped by type and by State
 - e. View Vertical Well
 - f. View Horizontal Well

- Setting up and Feeding Data to Wellbore
 - a. Overview of Data Service
 - b. Software Requirements
 - c. Accessing the service
 - d. Why Data Service is Important
 - e. Step by Step Setup
 - f. Verify Configuration is working

- In Closing / What's next?

Colorado use of RBDMS Environmental (Arthur Koepsell)

RBDMS UIC Module Update (Don Drazan)

1:30 – 5:00

Afternoon Session: *Sunset Terrace, 8th Floor*

eForm: Dave Lowther, Tom Kropatsch, Dan Jarvis

- eForm Today and in the Future
 - a. UT and WY Business Requirements (with Dan Jarvis and Tom Kropatsch)
 - b. Demonstration of UT and WY Features
 - c. What's next? Supporting existing installations and current development while growing eForm

Data Portal (Data Mining): *Hands On* (Dave Lowther)

- [Click here to preview the latest Utah Data Portal beta](#)

- a. Application Structure Overview
- b. Simple Search – Configuring Nodes and Details
- c. Reports – Rights, Menus, Filters
- d. Grid-style Reports – SQL and Layout Configuration
- e. Role-Based Configuration – Revisiting Nodes, Details, and Menus
- f. GIS Configuration Walk-Through

6:00 – 8:00

Evening Networking: *South Tower Room 1213*

Thursday, April 6

8:00

Breakfast: *Reception Area, 8th Floor*

8:30 – 12:00

Morning Session: *Royal Palm Room, 8th Floor*

Gateway user interface: Shirley Neff (EIA)/REI Systems

- Architectural and technology discussion
- Transfer of data from states to Gateway/Wellfinder

User Interface Update

Utah RBDMS Data Portal: [Click here to view](#)

Michigan RBDMS Data Portal: [Click here to view](#)

National Oil and Gas Gateway: <https://test-eia.reisystems.com/explore>

California User Interface

Colorado use of Power B I: [Click here to view](#)

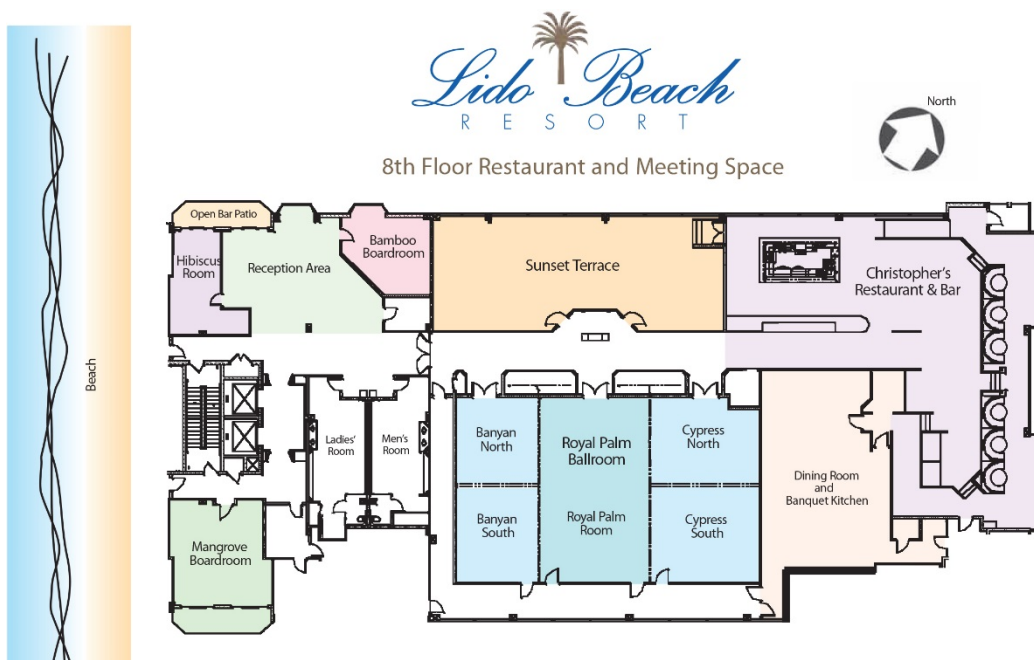

Upcoming GWPC Events:



RBDMS Fall Policy Meeting

Tentative: Sacramento
November 14 – 16, 2017

BOSTON | SEPT. 27-29, 2017

ANNUAL FORUM



Boston Sheraton

Call for Abstracts, Agenda, Detailed Information Coming Soon!

www.gwpc.org/events